

Office to let

The Bridge Business Park - Phase I

Bucharest, Sector 6, blvd. Orhideelor 15D



Building information

Building status	Existing
Year of construction	2017
Parking ratio	1 / 80 sq m
Total building area	51 591 sq m

Commercial terms

Office space*	after login *
Parking	after login *
Service charge*	after login *
Minimum lease term	after login *
Availability	after login *

* Asking terms for m²/month

Location



Available space

Building completely leased

Typical floor plan

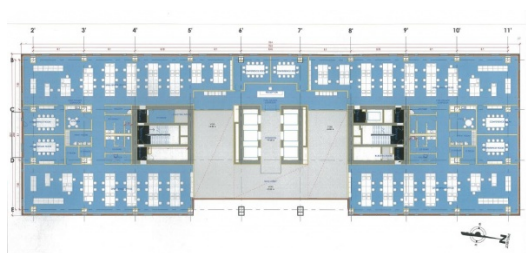

Public transport

Metro: M1, M4

Bus: 601, 105

Tram: 11

Contact



+40 21 302 3400

More information